

**ISOMETRIC VIEW
(FRONT)**

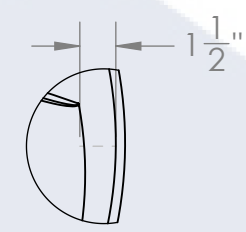

**DETAIL 1C
SCALE 1 : 8**

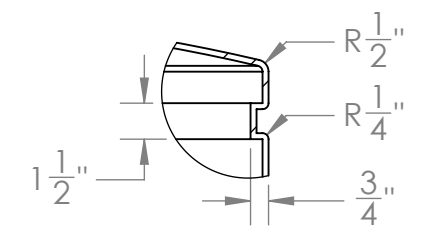

**DETAIL 1A
SCALE 1 : 8**

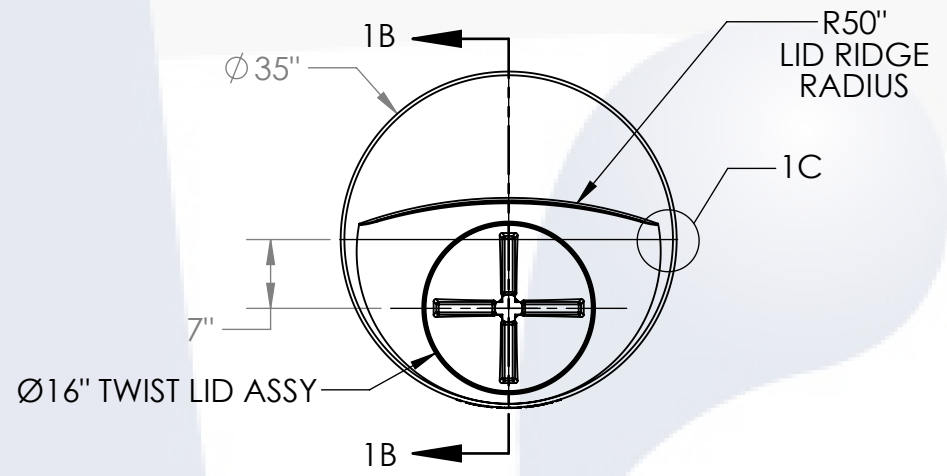

PLAN VIEW

1°
LID ANGLE

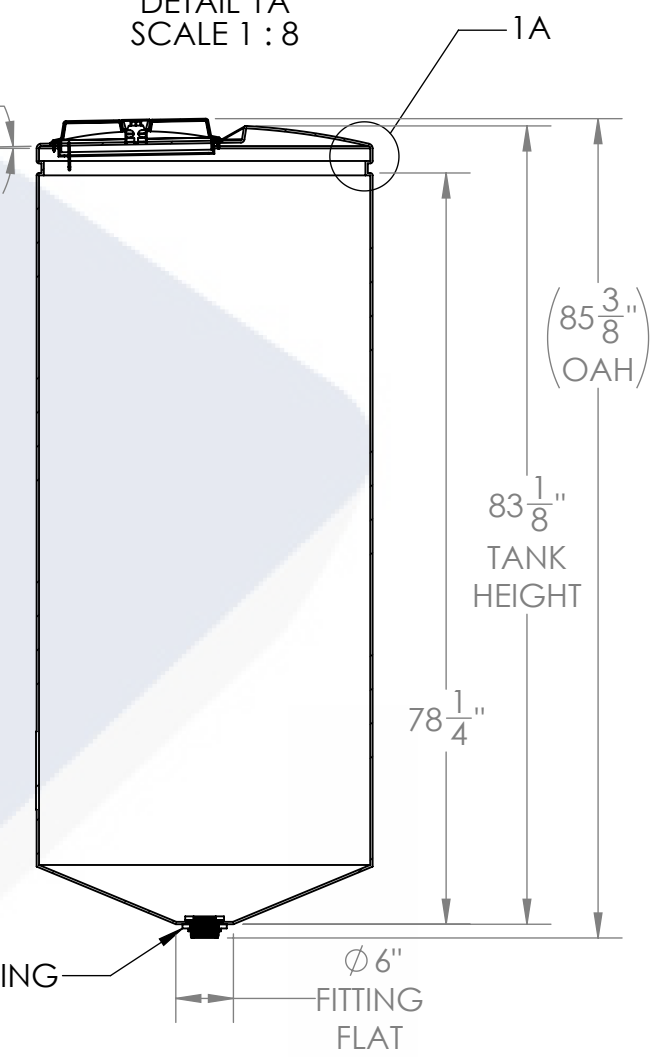

SECTION 1B-1B

- NOTES:**
- CAPACITY: 300 GAL. NOMINAL
 - TANK MATERIAL: MDPE
 - SERVICE PRESSURE: ATMOSPHERIC
 - NSF/ANSI STANDARD 61 CERTIFIED

PROPRIETARY AND CONFIDENTIAL
THE INFORMATION CONTAINED IN THIS DRAWING IS THE SOLE PROPERTY OF PEABODY ENGINEERING. ANY REPRODUCTION IN PART OR AS A WHOLE WITHOUT THE WRITTEN PERMISSION OF PEABODY ENGINEERING IS PROHIBITED.

UNLESS OTHERWISE SPECIFIED:		NAME	DATE	
DIMENSIONS ARE IN INCHES TOLERANCES: ±1/4" ANGULAR: ± .5° ONE PLACE DECIMAL: ± .25 TWO PLACE DECIMAL: ± .125 THREE PLACE DECIMAL: ± .063		DRAWN	SMF 03/01/23	
TANK MATERIAL:		CHECKED		PROJECT: PROCHEM® TANKS
INNER TANK S/N:		ENG APPR.		CUSTOMER: PEABODY STANDARD
OUTER TANK S/N:		MFG APPR.		SITE/LOCATION: -
CUSTOMER PO#		Q.A.		SALES ORDER: -
DO NOT SCALE DRAWING				SIZE B DESC. 300GAL CONE BOTTOM TANK REV. B
				SCALE: 1:20 SHEET 1 OF 1